

|                  |              |
|------------------|--------------|
| Item #: _____    | Qty #: _____ |
| Model #: _____   |              |
| Project #: _____ |              |



**H2S-H2G Series**  
with Undershelf



**TH2S-TH2G Series**  
with Open Base

**1 3/4" WOOD TOP with UNDERSHELF**  
Stainless Steel Base      Galvanized Base

| Length | 24"     | 30"     | 36"     | 24"     | 30"     | 36"     |
|--------|---------|---------|---------|---------|---------|---------|
| 36"    | H2S-243 | H2S-303 | H2S-363 | H2G-243 | H2G-303 | H2G-363 |
| 48"    | H2S-244 | H2S-304 | H2S-364 | H2G-244 | H2G-304 | H2G-364 |
| 60"    | H2S-245 | H2S-305 | H2S-365 | H2G-245 | H2G-305 | H2G-365 |
| 72"    | H2S-246 | H2S-306 | H2S-366 | H2G-246 | H2G-306 | H2G-366 |
| 84"    | H2S-247 | H2S-307 | H2S-367 | H2G-247 | H2G-307 | H2G-367 |
| 96"    | H2S-248 | H2S-308 | H2S-368 | H2G-248 | H2G-308 | H2G-368 |

Shipping weight approximately 25 lbs. per lineal foot.  
Units 8 ft. and larger are furnished with six (6) legs

**1 3/4" WOOD TOP with OPEN BASE**  
Stainless Steel Base      Galvanized Base

| Length | 24"      | 30"      | 36"      | 24"      | 30"      | 36"      |
|--------|----------|----------|----------|----------|----------|----------|
| 48"    | TH2S-244 | TH2S-304 | TH2S-364 | TH2G-244 | TH2G-304 | TH2G-364 |
| 60"    | TH2S-245 | TH2S-305 | TH2S-365 | TH2G-245 | TH2G-305 | TH2G-365 |
| 72"    | TH2S-246 | TH2S-306 | TH2S-366 | TH2G-246 | TH2G-306 | TH2G-366 |
| 84"    | TH2S-247 | TH2S-307 | TH2S-367 | TH2G-247 | TH2G-307 | TH2G-367 |
| 96"    | TH2S-248 | TH2S-308 | TH2S-368 | TH2G-248 | TH2G-308 | TH2G-368 |

Shipping weight approximately 25 lbs. per lineal foot.  
Units 8 ft. and larger are furnished with six (6) legs

**FEATURES & CONSTRUCTION:**

Hard Wood Top.  
Gussets welded to support channels.

**H2S & H2G Series**

Aluminum die cast "leg-to-shelf" clamp secures shelf to leg eliminating unsightly nuts and bolts. Undershelf is adjustable.

**TH2S & TH2G**

Front to back Stretchers are welded to legs. Left to right Stretcher bolted to legs and requires assembly.

**H2S & TH2S Series**

**MATERIAL:**

**TOP:** Laminated 1-3/4" Thick  
HARD MAPLE.

**SHELF:** 18 gauge stainless steel.

**LEGS:** 1 5/8" diameter tubular stainless steel.

Stainless steel gussets.

1" adjustable stainless steel bullet feet.

**H2G & TH2G Series**

**MATERIAL:**

**TOP:** Laminated 1-3/4" Thick  
HARD MAPLE.

**SHELF:** Galvanized steel.

**LEGS:** 1 5/8" diameter tubular galvanized steel.

Galvanized steel gussets.

1" adjustable plastic bullet feet.

# DETAILS and SPECIFICATIONS

TOL ± .500"

ALL DIMENSIONS ARE TYPICAL

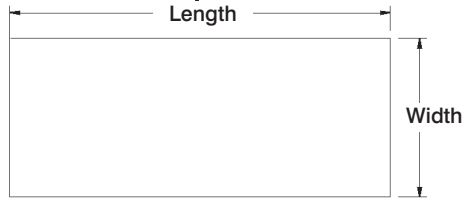

## H2S & H2G Series Undershelf Style

Finished size of undershelf = Length minus 5 3/4", Width minus 5 3/4"  
Units 8 ft. and larger are furnished with six (6) legs

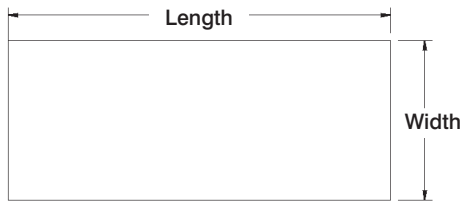
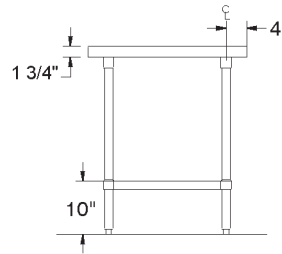
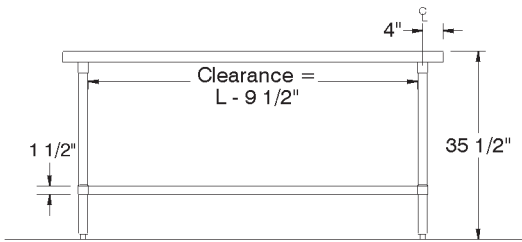

## TH2S & TH2G Series Open Base Style

Units 8 ft. and larger are furnished with six (6) legs

