



MBSP48-12A



## MBSP-A SERIES

### Sandwich/Salad Prep Units

#### MODELS

- MBSP27-8A     MBSP36-10A     MBSP48-12A  
 MBSP60-16A     MBSP72-18A



#### Drop-in section:

- Fans force cold air into this enclosed area keeping stored food items consistently cold
- A stainless steel divider prevents food spillage into the storage area beneath
- Accommodates 6" deep pans (4" standard)

### FEATURES

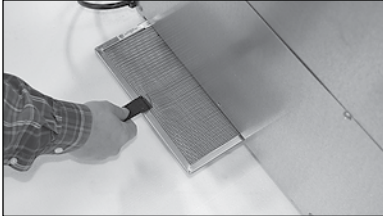

*Standard condenser filter screen, removable without tools, for easy condenser coil cleaning resulting in peak efficiency and extended equipment life.*

#### CONSTRUCTION

- Front-breathing design allows for zero-clearance installation on sides and back
- Stainless steel interior and exterior
- Foamed-in-place with low ODP polyurethane insulation
- Standard 9<sup>1</sup>/<sub>2</sub>" deep reversible cutting board
- Insulated top lid
- Wall thickness: 2.0"
- 6" overall height casters
- Adjustable heavy-duty vinyl-coated shelves

- Field reversible door on MBSP27-8A
- 1/6 size pans included in all models
- Locking adapter bars hold pans in place

#### DOORS

- Self-closing
- Standard door swing configuration:
  - 1-door models ..... hinged right
  - 2-door models.....left hinged left, right hinged right
  - 3-door models.....left hinged left, middle hinged left, right hinged right
- Door width:
  - MBSP27-8A ..... 27<sup>1</sup>/<sub>2</sub>"
  - MBSP36-10A..... 17<sup>1</sup>/<sub>2</sub>"
  - MBSP48-12A ..... 23<sup>1</sup>/<sub>2</sub>"
  - MBSP60-16A ..... 29<sup>1</sup>/<sub>2</sub>"
  - MBSP72-18A..... 23<sup>1</sup>/<sub>2</sub>"

#### REFRIGERATION

- Self-contained forced air refrigeration system
- Coated evaporator coil
- Refrigerant: R-134a
- Temperature range: 34° to 38°F (1° to 3°C) for storage area; 33° to 41°F (1° to 5°C) for refrigerated pan well

#### WARRANTY

- **Standard limited three year parts and labor**
- **Additional two year coverage on compressor part**

### OPTIONS

- 6" legs in lieu of casters (legs shipped loose)
- 4" casters in lieu of 6" casters (casters shipped loose)
- Stainless steel back
- Additional shelves
- Single or double overself



- Refrigerated drawers (excluding MBSP36-10A)



# TECHNICAL SPECIFICATIONS

MODEL	DIMENSIONS (in.)			DIMENSIONS (mm)			VOLTS	AMPS	UNIT H.P.	NO. OF DOORS	NO. OF SHELVES	NO. OF PANS	CAP. CU. FT.	SHIP CU. FT.	SHIP WT. (LB/KG)
	L	D	H*	L	D	H*									
MBSP27-8A	27 <sup>1/2</sup>	30	43 <sup>3/4</sup>	699	762	1111	115	3.6	1/5	1	1	(8) 1/6	7.2	26.3	208/94
MBSP36-10A	36	30	43 <sup>3/4</sup>	914	762	1111	115	3.6	1/5	2	2	(10) 1/6	9.9	33.1	261/118
MBSP48-12A	48	30	43 <sup>3/4</sup>	1219	762	1111	115	5.2	3/8	2	2	(12) 1/6	13.4	42.7	317/144
MBSP60-16A	60	30	43 <sup>3/4</sup>	1524	762	1111	115	5.2	3/8	2	2	(16) 1/6	16.2	52.3	368/167
MBSP72-18A	72	30	43 <sup>3/4</sup>	1829	762	1111	115	5.2	3/8	3	3	(18) 1/6	20.4	61.9	426/193

\*Height includes casters.

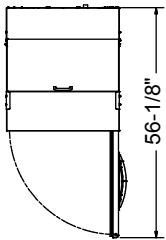

MBSP27-8A  
PLAN VIEW

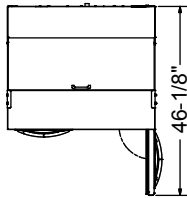

MBSP36-10A  
PLAN VIEW

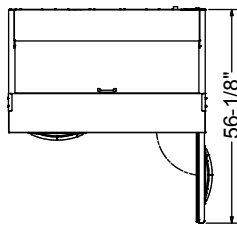

MBSP48-12A  
PLAN VIEW

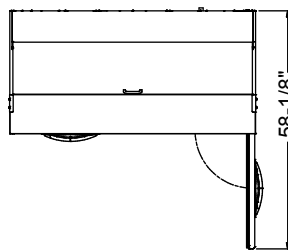

MBSP60-16A  
PLAN VIEW

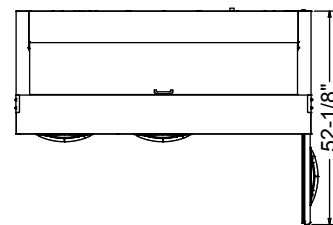

MBSP72-18A  
PLAN VIEW

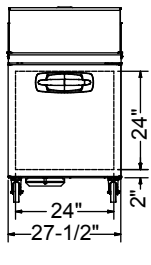

MBSP27-8A  
ELEVATION  
VIEW

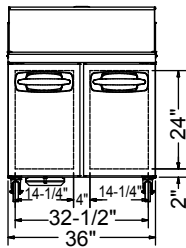

MBSP36-10A  
ELEVATION  
VIEW

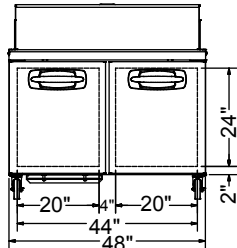

MBSP48-12A  
ELEVATION  
VIEW

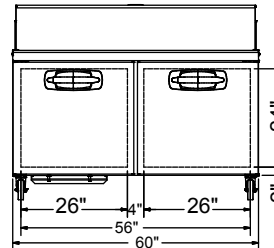

MBSP60-16A  
ELEVATION  
VIEW

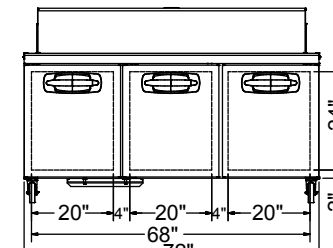

MBSP72-18A  
ELEVATION  
VIEW

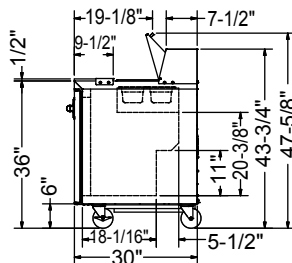

ALL MODELS  
SIDE VIEW

## LISTINGS



## HOOUP

All models via plug in, 9 foot long flexible three wire 18/3 cord with molded plug.

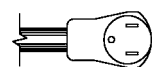

NEMA 5-15P

**OPTIONAL REFRIGERATED DRAWER CONFIGURATIONS (Not available on MBSP36-10A model)**

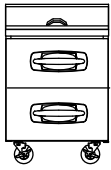

MBSP27-8A-001

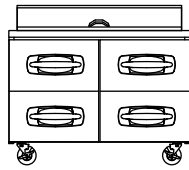

MBSP48-12A-001

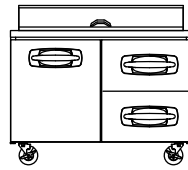

MBSP48-12A-002

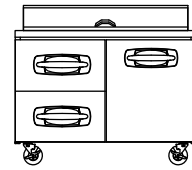

MBSP48-12A-003

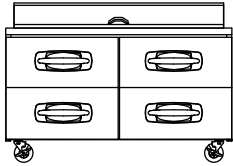

MBSP60-16A-001

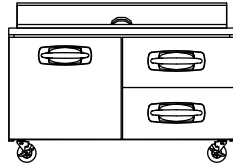

MBSP60-16A-002

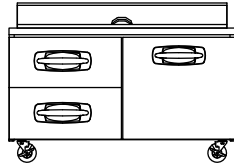

MBSP60-16A-003

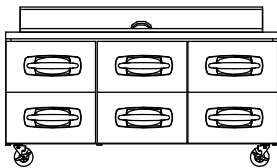

MBSP72-18A-001

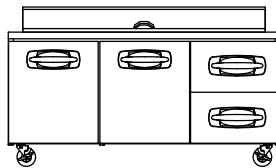

MBSP72-18A-002

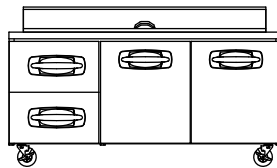

MBSP72-18A-003

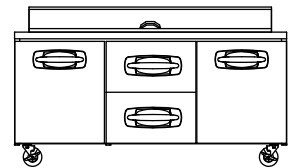

MBSP72-18A-004

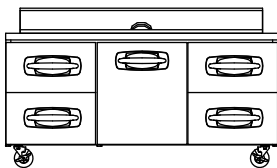

MBSP72-18A-005

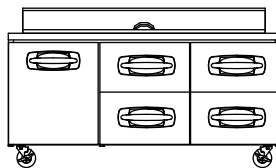

MBSP72-18A-006

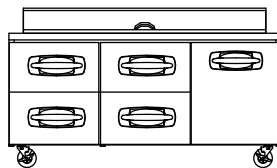

MBSP72-18A-007

**PAN CONFIGURATIONS FOR REFRIGERATED DRAWERS (Not available on MBSP36-10A model)**

MBSP27-8A

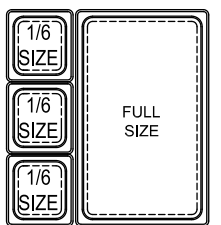

DRAWER FRONT

TOP DRAWER

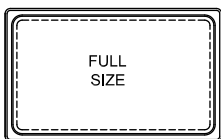

BOTTOM DRAWER

MBSP48-12A & MBSP72-18A

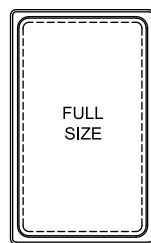

DRAWER FRONT

TOP DRAWER

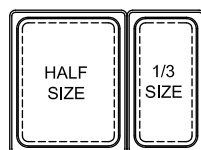

BOTTOM DRAWER

MBSP60-16A

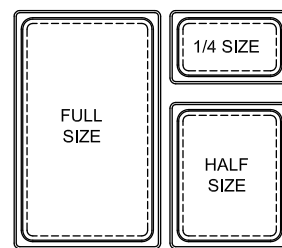

DRAWER FRONT

TOP DRAWER

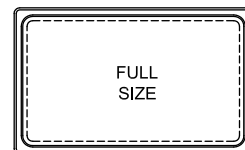

BOTTOM DRAWER

\*U.S. size pans, pans provided by others. Drawers accept up to 6-inch deep pans.

### OPTIONAL OVERSHELF SPECIFICATIONS

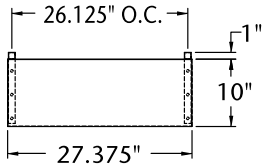

PLAN VIEW  
MBSP27-8A, MBSMP27-12A

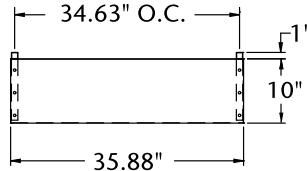

PLAN VIEW  
MBSP36-10A, MBSMP36-15A

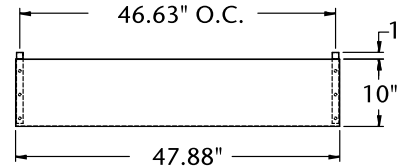

PLAN VIEW  
MBSP48-12A, MBSMP48-18A

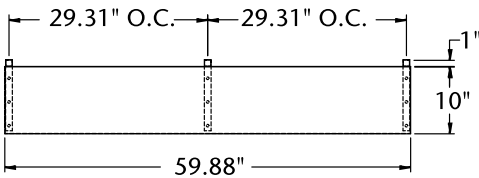

PLAN VIEW  
MBSP60-16A, MBSMP60-24A

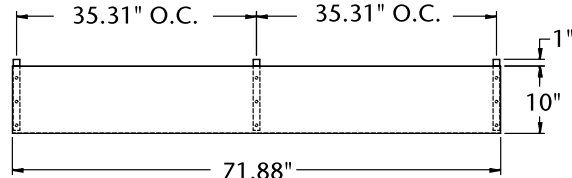

PLAN VIEW  
MBSP72-18A, MBSMP72-30A

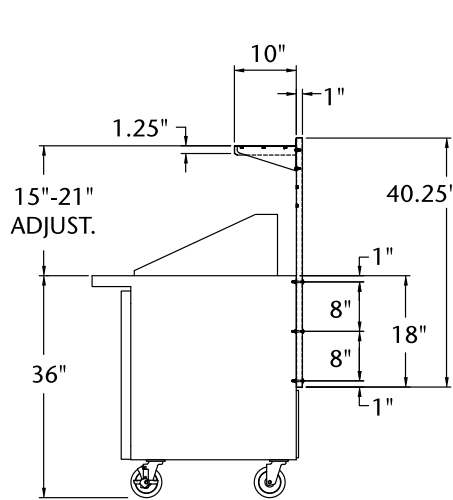

SINGLE SHELF SIDE VIEW

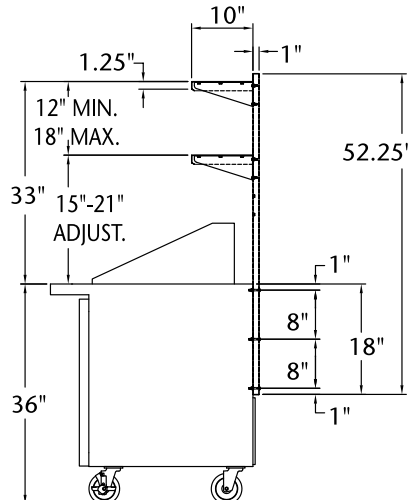

DOUBLE SHELF SIDE VIEW

### BID SPECIFICATIONS

Item no. MBSP\_\_\_\_\_. Provide \_\_\_\_\_ Sandwich/Salad Prep Unit(s), Master-Bilt® model no. MBSP\_\_\_\_A.

Prep unit will feature will feature condenser coil filter screen, removable without tools, for simple preventative maintenance cleaning.

Prep unit will feature stainless steel

construction on interior and exterior and will be equipped with locking adapter bars to hold pans in place.

The refrigeration system will be bottom mounted and self-contained. System will be front-breathing allowing for zero-clearance installation on sides and back.

Refrigerant will be R-134a. The temperature

range will be 32° to 40°F (0° to 4° C).

Prep unit to have standard limited three year parts and labor with additional two year coverage on compressor part.

Prep unit will be UL & C-UL listed and UL EPH classified.

**NOTE: Cabinet designed for optimum performance in air-conditioned area at 75°F ambient and 55% relative humidity. All specifications subject to change without notice.**