

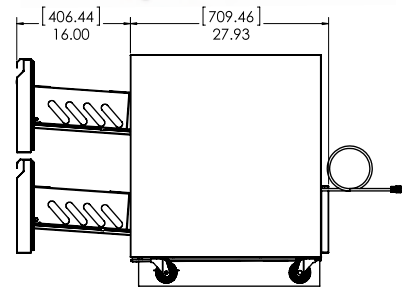

27" Freezer

MODEL DEFF-27SD-1-BK1

MODEL DEFF-27D2-1-BK1

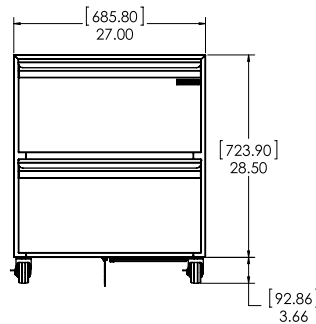
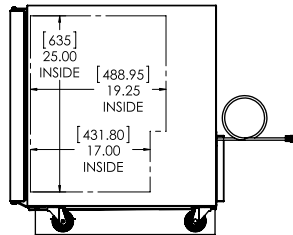
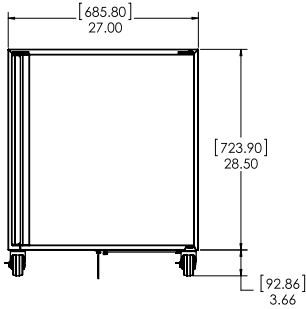
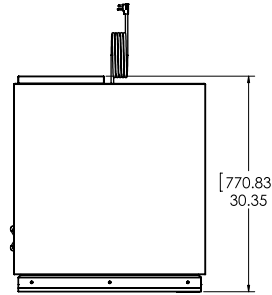
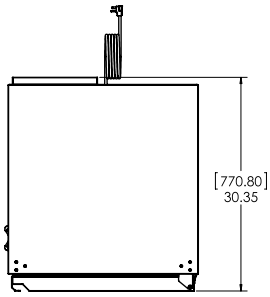

MODEL	LENGTH	DEPTH	HEIGHT	CAPACITY	AMPS	WEIGHT
DEFF-27SD-1-BK1	27"	30-3/8"	32-1/8"	6 1/2 cu. ft.	3.2	170 lbs.
DEFF-27D2-1-BK1	27"	30-3/8"	32-1/8"	2 Full size pans-6" deep	3.2	215 lbs.

- EXTERIOR** Stainless steel. Galvanized back and bottom.
- INTERIOR** Aluminum, Coved corners and finished edges for ease of cleaning.
- INSULATION** Environmentally friendly polyurethane foamed-in-place for maximum insulation, strength and durability.
- CASTERS** Supplied with four casters (two with locks).
- REFRIGERATION** CFC-free, 134A refrigerant, hermetically sealed, high efficiency, self contained refrigeration system automatic defrost and forced air circulation. Automatic condensate evaporator means no plumbing or floor drains.
- DOOR GASKETS** Santo Prene material lasts four times industry standard.
- ELECTRICAL** Standard 115 volt, 60 Hz, single phase. 8 foot 3-wire power cord with NEMA 5-15 plug.
- LISTINGS** ETL Safety (U.S. and Canada), ETL Sanitation.
- WARRANTY** 1 year parts and labor, five year warranty on compressor.



1600 Xenium Lane North
 Minneapolis, MN 55441-3787
 Phone (763) 923-2441
 Fax (763) 553-1209
 www.silverking.com



Specifications subject to change without notice.

1/2016
 © Silver King 2016
 Printed in U.S.A.