



Electrolux

Hand held Mixers Bermixer PRO 750W with Stainless Steel Tube 26" with constant pressure switch

ITEM # _____

MODEL # _____

NAME # _____

SIS # _____

AIA # _____



Hand held Mixers

Bermixer PRO 750W with Stainless Steel Tube 26" with constant pressure switch

600389
(BP7565U)

Bermier PRO, portable, hand held, variable speed (up to 10000 RPM), equipped with constant pressure switch, handle grip, with 26" cutter tube attachment, 750 watt, NEMA 1-15P

Short Form Specification

Item No. _____

Bermixer PRO, portable, hand held immersion blender, variable speed, handle grip, with 26" stainless steel cutter tube, 1 HP, 750 watt, 115v/60/1. Stainless steel tubes (various lengths) and whisk available upon request as an accessory, to mix, liquidize, whip or emulsify.

IP55 water protected control panel.

With NEMA 5-15P Plug

With Constant Pressure Switch

Main Features

- Parts in contact with food - tube, blade, shaft - can be completely dismantled without tools for easy cleaning.
- Delivered with:
 - flat base motor
 - stainless steel tube
 - space saving storing wall support.
- Anti-splash bell knife design.
- Tube, knife and whisks are dishwasher safe.
- Safety feature requires both hands to start the mixer (no volt release system).
- Light weight, ergonomic grip and adjustable speeds make preparation tasks fast and easy.
- Overheating warning red indicator.
- Bayonet system makes fast and simple to exchange tools.

Construction

- Motor has an air cooling system and is protected against overheating (in case of long intensive work).
- Maximum speed 10000 rpm.
- Power: 750 watts (1 HP).
- Smart speed control to ensure the right power according to the work load.
- Water protected motor unit (controls are IP55, IP34 throughout machine).

Included Accessories

- 1 of Stainless Steel cutter tube 26in (553mm) PNC 650135

Optional Accessories

- Stainless Steel cutter tube 14in (353mm) PNC 650132
- Stainless Steel cutter tube 18in (453mm) PNC 650133
- Stainless Steel cutter tube 22in (553mm) PNC 650134
- Stainless Steel cutter tube 26in (553mm) PNC 650135
- Adjustable rail, for containers 15in - 26in PNC 653292
- Bowl cradle for containers PNC 653294
- Reinforced whisk 10in PNC 653578



APPROVAL: _____

Electrolux Professional, Inc.

www.electroluxusa.com/professional

10200 David Taylor Drive, Charlotte, NC 28262 • Telephone Number: 866-449-4200 • Fax Number: 704-547-7401



Electrolux

Bermixer PRO 750W with Stainless Steel Tube 26" with constant pressure switch

Hand held Mixers

Front

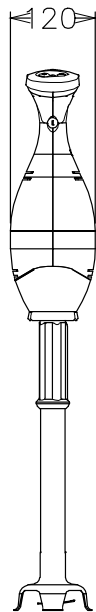

Top

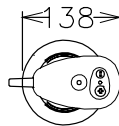

EI = Electrical connection

Side

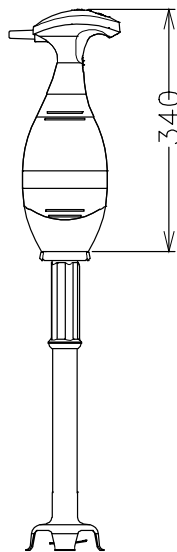

Electric

Supply voltage:	600389 (BP7565U)	100-120 V/1N ph/50/60 Hz
Total Watts:		0.75 kW
Plug type:		USA NEMA 5-15P

Key Information:

External dimensions, Width:	5 7/16" (138 mm)
External dimensions, Depth:	4 3/4" (120 mm)
External dimensions, Height:	38 " (965 mm)
Shipping width:	14 9/16" (370 mm)
Shipping depth:	27 9/16" (700 mm)
Shipping height:	5 1/8" (130 mm)
Shipping weight:	11 lbs (5 kg)