

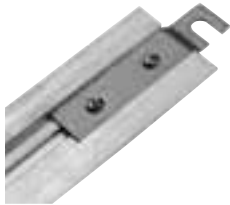

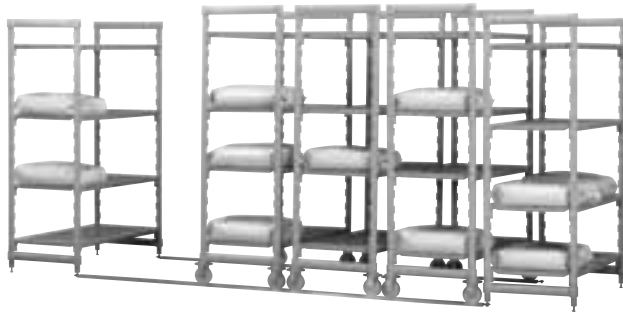

## Full Track and Extension Kits

Aluminum raised track kits and track extensions ship complete in 1 box. Each kit includes all stainless steel hardware necessary to complete a floor installation.

It is highly recommended to install a stationary starter unit every 15' of track to further stabilize the system.



CODE	DESCRIPTION	CASE PACK
<b>Floor Track Kit</b>		
CSMHDTK10	10' Track for 3 Mobile Units*	1
CSMHDTK12	12' Track for 4 Mobile Units*	1
CSMHDTK145	14.5' Track for 5 Mobile Units*	1
<b>Floor Track Extension</b>		
 CSMHDTKE4	4.5' Track Extension	1
 CSMHDTKE5	5' Track Extension	1
 CSMHDTKE6	6' Track Extension	1

**Color:** Silver (000). \*Based on 24" deep mobile units.

## High Density Caster with Donut Bumper



CODE	SIZE
CPMCHD	5"
<b>Case Pack:</b> 2	<b>Color:</b> Gray (000).

