

# Underbar Hand Sink w/ Soap/Towel Dispensers

## 21" Wide Units - Deep Drawn Bowl NSF



SC-15-TS



SC-15-TS-S

Item #: \_\_\_\_\_ Qty #: \_\_\_\_\_

Model #: \_\_\_\_\_

Project #: \_\_\_\_\_

**Featuring Deep Drawn  
Seamless Bowl**



### FEATURES:

Free standing unit.

One piece **Deep Drawn** sink bowl measuring 9" x 9" x 4".

Built-in deck mount soap dispenser and c-fold towel dispenser.

6" deck mounted faucet.

4" backsplash.

SC-12-TS-S & SC-15-TS-S Series has 4" Side Splashes.

Galvanized legs with adjustable plastic bullet feet.

Adjustable galvanized side cross-bracing.

Has rear deck for extra storage.

**-TS-S models** include 4" high side splashes.

### MECHANICAL:

K-51 deck mount swing spout faucet

**Faucet meets federal lead free standards.**

1 1/2" basket drain with 1 1/2" IPS

### MATERIAL:

**Sink Bowl & Sides:** 20 gauge, 300 stainless steel

**Front Apron, Door, Backsplash:** 22 gauge, 300 stainless steel

**Optional Side Splash:** 16 gauge, 300 stainless steel

**Legs:** 1 5/8" O.D. 18 gauge, galvanized steel  
with adjustable plastic bullet feet

### OPTIONAL:

**A-15** - Chrome towel ring (packed loose)

**K-12** - Replacement deck mount soap dispenser

**K-316-LU** - Add wrist handles

**SU-10C** - 14" stainless steel leg upgrade with cross-bracing

### Standard

Model #	Length (L)	Width (W)	Approx. Weight	Approx. Cu. Ft.
SC-12-TS	12"	21"	45 lbs.	4
SC-15-TS	15"	21"	49 lbs.	4

### w/ Side Splashes

Model #	Length (L)	Width (W)	Approx. Weight	Approx. Cu. Ft.
SC-12-TS-S	12"	21"	50 lbs.	4
SC-15-TS-S	15"	21"	54 lbs.	4

# DIMENSIONS and SPECIFICATIONS

TOL Overall:  $\pm .500"$  Interior:  $\pm .250"$

ALL DIMENSIONS ARE TYPICAL

## SC-12-TS/SC-15-TS

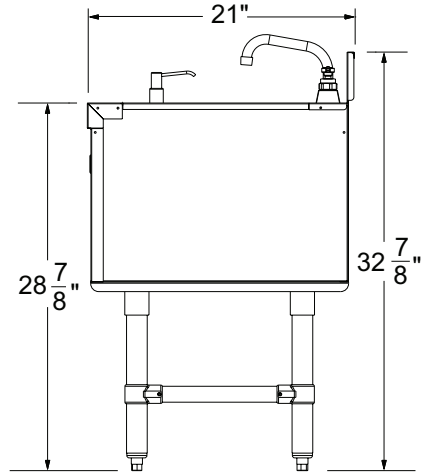
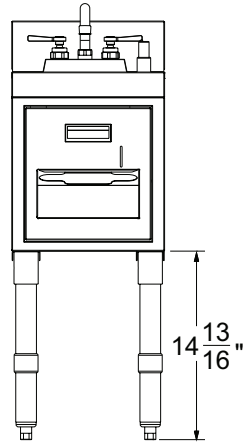
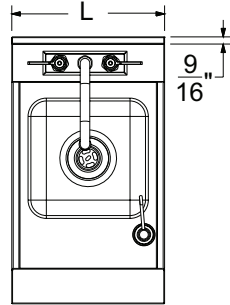

## SC-12-TS-S/SC-15-TS-S

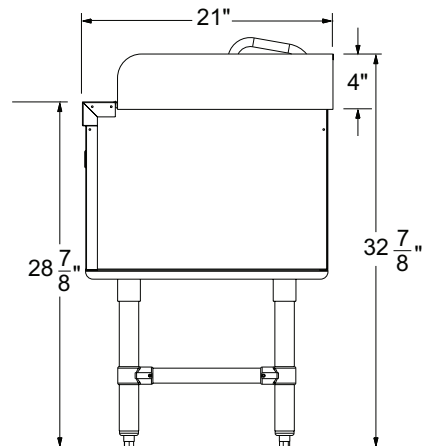
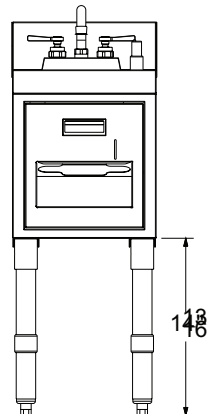
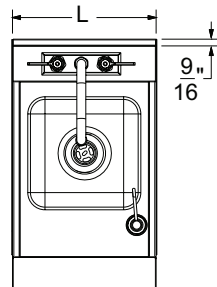

ADVANCE TABCO is constantly engaged in a program of improving our products. Therefore, we reserve the right to change specifications without prior notice.

© ADVANCE TABCO, AUGUST 2016