

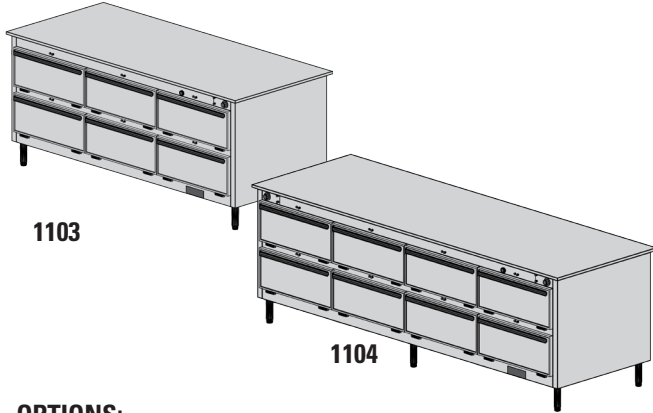

Your Solutions Partner

Specifications

F.O.B Sedalia, Missouri 65301



1103

1104

OPTIONS:

- Enclosed base - 6" high
- Cord and plug - 8'
- Casters - 5" polyurethane, 2 swivel w/brakes 2 rigid
- Push bar
- Bumpers - stainless steel
- Door Panels - laminated plastic
- Additional pair 5" angle slides
- Door locks
- 440-480V Circuit
- Celsius thermometer in lieu of Fahrenheit
- 208V/1Ph; 208V/3Ph; 240V/1 PH; 240/3PH

AGENCY LISTING:



DUKE MANUFACTURING CO.
2305 N. Broadway
St. Louis, MO 63102

800.735.3853 Toll Free
314.231.5074 Fax
www.dukemfg.com

SS-DM-00176-THM-03

Approval Stamp(s):

PRODUCT INFORMATION:

PROJECT: _____

ITEM: _____

QUANTITY: _____

MODEL:

Thermotainer Food Holding Cabinets - "B" Series 9"H x 22"W x 28-1/2" D Compartments

- 1103** Reach-In 1 thermostat for all 6 compartments, w/legs
- 1103P** Pass-Thru 1 thermostat for all 6 compartments, w/legs
- 1104** Reach-In 2 thermostat for all 8 compartments, w/legs
- 1104P** Pass-Thru 2 thermostat for all 8 compartments, w/legs

BODY:

- Heavy gauge stainless steel, all panels except bottom
- Shell welded to interior
- Die-stamped compartment openings
- Top 14 ga. S/S w/1" turned down edge and 1" overhang on all sides
- Body fully insulated with 1-1/2" fiberglass

DOORS:

- Stainless steel, die-stamped, embossed front
- Ribbed interior
- Reinforced for mounting hardware
- Insulated with fiberglass
- Spring hinges die-stamped, with built-in-stop externally adjustable, completely concealed

COMPARTMENT:

- Heavy gauge stainless steel
- Rounded corners
- Stainless steel studs for angle slides at 3 levels
- (2) removable, adjustable, stainless steel, 5" angled slide pairs
- Removable liner for inspection and maintenance

ELECTRICAL CONTROLS:

- Recessed thermostat w/built-in On-Off switch
- Heat range 100° - 300° and dial thermometer
- Pilot lights
- Recessed connection box
- Removable access panels

DAMPERS:

- 2-position sliding type
- Controlled by push buttons
- Compartments individually controlled

HEATING ELEMENTS:

- Sheath type strip heaters, 120 Volt, 1 Phase
- Removable compartment for ease of access to heating elements.

LEGS:

- Stainless steel die-stamped adjustable - 6" high

SHORT FORM SPECIFICATIONS:

Duke Thermotainers Food Holding Cabinets. Models **1103/1103P** constructed with six (6) compartments. Models **1104/1104P** to have eight (8) compartments. Compartments 9"H x 22"W x 28-1/2"D. Each compartment to have two (2) pairs of removable stainless steel slides. 1103/1103P - one thermostat controls all compartments. 1104/1104P - two thermostats controls all compartments. 14 ga. stainless steel work top. 100° - 300° heat range with dial thermometer, and 6" high stainless legs. Built-in installation - allow 1/4" tolerance greater than body width.



**THERMOTAINER FOOD HOLDING CABINETS - "B" SERIES
9"H x 22"W x 28-1/2"D COMPARTMENTS**

- ☐ **1103** Reach-In 1 thermostat for all 6 compartments, w/legs
- ☐ **1103P** Pass-Thru 1 thermostat for all 6 compartments w/legs
- ☐ **1104** Reach-In 2 thermostat for all 8 compartments, w/legs
- ☐ **1104P** Pass-Thru 2 thermostat for all 8 compartments w/legs

LEGEND	
▲	ELECTRICAL CONNECTION

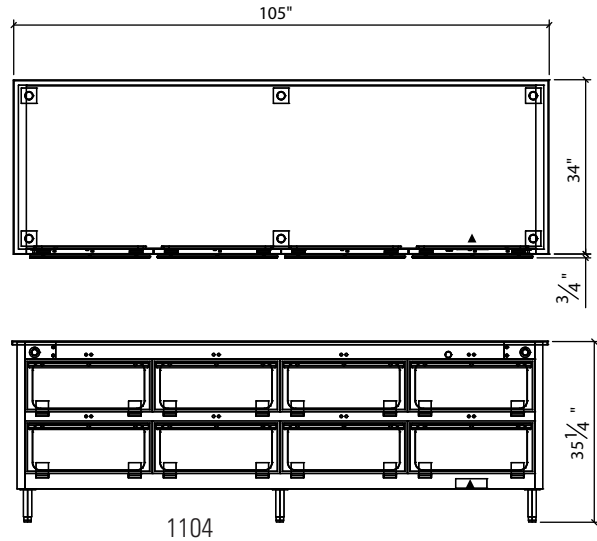
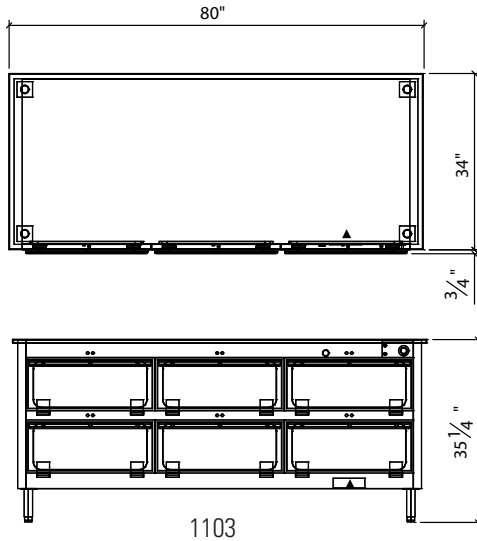

DIMENSIONS:

Freight Class: 100

Model	Width		Depth		Height		Comp. Depth		Cube ft. crated	Weight	
	in	cm	in	cm	in	cm	in	cm		lbs	kg
1103	80	203.2	33-3/4	85.7	35-1/4	89.5	28-1/2	72.4	83.4	800	363.6
1103P	80	203.2	35-1/2	90.2	35-1/4	89.5	30-1/2	77.5	85.0	800	363.6
1104	105	266.7	33-3/4	85.7	35-1/4	89.5	28-1/2	72.4	107.7	1050	477.3
1104P	105	266.7	35-1/2	90.2	35-1/4	89.5	30-1/2	77.5	109.7	1050	477.6

ELECTRICAL SPECIFICATIONS: (Consult factory for 3-phase electrical requirements and other options.) 120V,1PH

Model	Connected Load	Capacity w/standard slides
1103	2500 watts	(36) 12" x 20" x 2" pans or (24) 12" x 20" x 4" pans or (12) 12" x 20" x 8" pans or (18) 18" x 26" bake sheets
1103P	2500 watts	
1104	3000 watts	
1104P	3000 watts	

- 1103** Reach In - hinged doors on front only
- 1103P** Pass Thru - hinged doors on front & back for pass-thru service
- 1104** Reach In - hinged doors on front only
- 1104P** Pass Thru - hinged doors on front & back for pass-thru service



DUKE MANUFACTURING CO.

2305 N. Broadway
St. Louis, MO 63102

800.735.3853 Toll Free
314.231.1130 In Missouri
314.231.5074 Fax
www.dukemfg.com

Specification subject to change