

**G****2/3 JACKETED  
STATIONARY GAS KETTLE**

JOB NAME: \_\_\_\_\_

ITEM NO.: \_\_\_\_\_

NO. REQUIRED: \_\_\_\_\_

**MODELS**

- F-20GL - 20 gallon, gas stationary kettle
- F-30GL - 30 gallon, gas stationary kettle
- F-40GL - 40 gallon, gas stationary kettle
- F-60GL - 60 gallon, gas stationary kettle

**DESCRIPTION**

Market Forge self contained gas fired stationary steam kettle. The kettle has double-wall construction forming a steam jacket around the lower 2/3 of the vessel. The jacket enclosure contains factory sealed water and antifreeze. The kettle exterior is fully insulated. The bottom of the kettle is a hemispherical design for superior heat circulation. The recessed control panel is located on the front right side of the unit in full view of the operator. Standard controls include direct immersion thermostat, water sight glass, cooking light, pressure gauge and electronic ignition with ignition indicator light. Safety features include low water cut off, gas valve with gas pressure regulator, pressure switch and a 100% safety gas shut off valve. 316 stainless steel liner for high acid content products standard for 20-, 30- and 40-gallon.

The kettle is mounted on stainless steel 2" tri-legs with adjustable flanged feet. The kettle has as standard equipment a hinged cover, a 2" (51mm) diameter draw off valve and drain strainer.

The gas burner assembly includes a power burner. The pressurized steam generating section of the kettle will be fitted with a 50 PSI safety valve and an automatic air eliminator valve. Kettle construction is in accordance with the ASME code.

Model	Input BTU/Hour	Combustion Efficiency
F-20GL	100,000	78% Minimum
F-30GL	100,000	78% Minimum
F-40GL	100,000	75% Minimum
F-60GL	130,000	75% Minimum

**OPERATION WILL BE BY**

Natural or L.P. gas utilizing a high efficiency power burner system. The steam kettle is A.S.M.E. code stamped for operation to 50 PSI. Temperature range from 150°F to 285°F.

The controls shall be equipped for operation on:

- 120 VAC, 1pH, 50/60 Hz.



F40-GL shown

**SHIPPING WEIGHT**

- F-20GL - 440 lbs (200 kg)
- F-30GL - 575 lbs (261 kg)
- F-40GL - 600 lbs (272 kg)
- F-60GL - 720 lbs (326 kg)

**OPTIONS & ACCESSORIES**

(at additional charge)

- **Pantry Faucet**
  - Single Pantry Faucet with Swing Spout
  - Double Pantry Faucet with Swing Spout
- Stainless Steel Tri-Basket
- 316 Stainless Steel Liner for High Acid Content Products (Standard on 20, 30 & 40-Gallon)
- Graduated Measuring Strip
- 3" Draw-Off Valve
- Solid Draw-Off Strainer
- Spring Assist Cover for 20, 30 & 40-Gallon (Standard on F-60GL)
- Etched gallon markings
- Lip strainer

**FOOD SERVICE EQUIPMENT**  
Stationary Gas Kettle
**MARKET FORGE**

# G

## 2/3 JACKETED STATIONARY GAS KETTLE

DETAILS & DIMENSIONS

### GAS SPECIFICATIONS

MODEL	SUPPLY PRESSURE (W.C.)		BTU/Hr.	kW/Hr.	MINIMUM CLEARANCE*	
	Natural	Propane			Sides	Back
F-20GL, F-30GL, F-40GL	6"-14" (152-355)	11"-14" (279-355)	100,000	29.3	6" (152)	2" (51)
F-60GL			130,000	38.1		

### SERVICE CONNECTIONS

<b>EC</b>	<b>Electrical Connection</b> - 120 Volt, 60Hz, 1pH, furnished with 6 ft. cord with 3 pronged plug. Total Max. Amps 2.0.
<b>G</b>	<b>Gas Connection</b> - 3/4" (19mm) N.P.T.

\* Use on non-combustible floors only.

### DIMENSIONS

MODEL	A	B	C	D	E	F	G	H	J	K
F-20GL	20 [508]	18.38 [467]	31.13 [791]	40.38 [1026]	65.38 [1661]	20 [508]	3.13 [79]	24.75 [629]	31.5 [800]	6.25 [159]
F-30GL	26 [660]	17.75 [451]	35.5 [902]	39.5 [1003]	69.75 [1772]	19.75 [502]	2.75 [70]	34.63 [879]	34.88 [886]	6.25 [159]
F-40GL	26 [660]	22.13 [562]	35.5 [902]	43.88 [1114]	74.63 [1895]	19.75 [502]	2.75 [70]	34.63 [879]	34.88 [886]	6.25 [159]
F-60GL	30 [762]	24.75 [629]	39.75 [1010]	49.38 [1254]	86.5 [2197]	22.5 [572]	2.75 [70]	34.63 [879]	38.38 [975]	8.25 [210]

FOOD SERVICE EQUIPMENT  
Stationary Gas Kettle

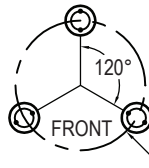

20 GALLON = Ø20.75 [527]  
 30 GALLON = Ø26.75 [679]  
 40 GALLON = Ø26.75 [679]  
 60 GALLON = Ø30.75 [781]

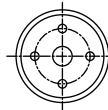

**FLANGED FEET DETAIL**  
 4 EQUALLY SPACE  
 Ø7/16" [11MM] HOLES  
 ON 2.835" [72MM] B.C.

DIMENSIONS ARE IN INCHES [MM]

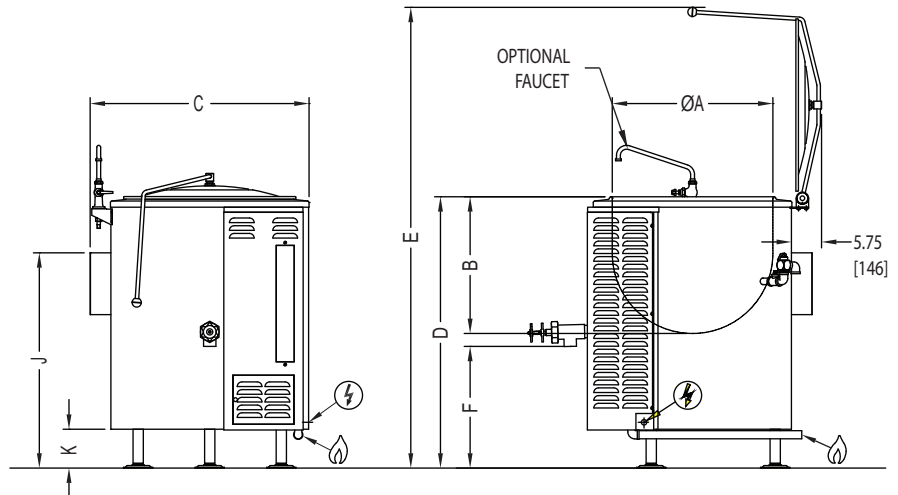
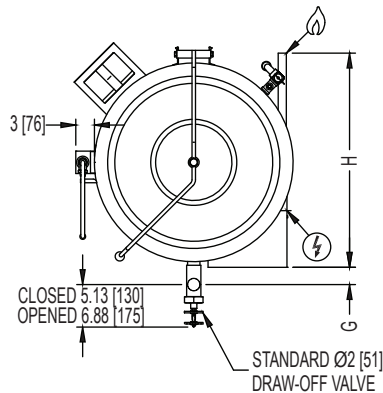

The manufacturer reserves the right to modify materials and specifications without notice.

