

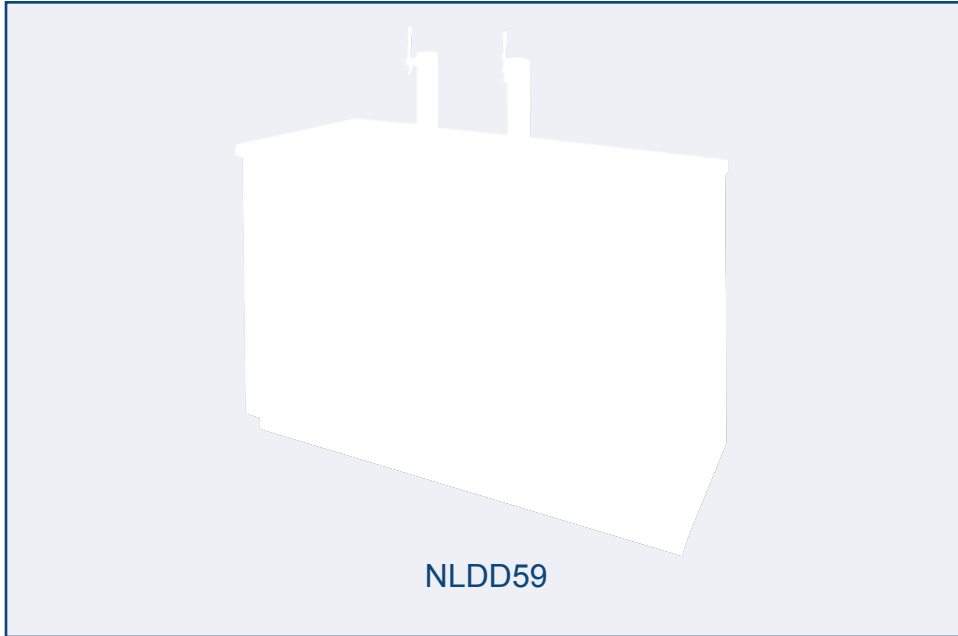

NOR-LAKE, INCORPORATED  
727 Second Street  
Hudson, Wisconsin 54016

800-955-5253  
715-386-2323  
866-961-5253 Parts  
800-388-5253 Service  
715-386-6149 FAX  
www.norlake.com

## ADVANTEDGE™ DIRECT DRAW BEER COOLERS



PROJECT:  
.....  
ITEM NUMBER:  
.....  
MODEL NUMBER:  
.....

### SPECIFICATIONS FOR: NLDD24, NLDD59, NLDD69, NLDD79, NLDD95

- **Finish:** Heavy duty stainless steel top, black front, sides and back. Galvanized steel interior walls with stainless steel floor.
- **Insulation:** Foamed-in-place 1-1/2" CFC free polyurethane insulation
- **Hardware:** Solid doors with locks, magnetic door gaskets, plastic breaker strips around door openings to limit the formation of any condensation. Interior LED light (except NLDD24). 3" diameter stainless steel draft towers. Heavy duty stainless steel threshold. Casters standard on NLDD24 model only.
- **Electrical:** 115 volt, 60 Hz, 1 phase with cord and NEMA 5-15P plug
- **Refrigeration:** Self-contained forced air R-134a capillary tube refrigeration system. Temperature range from +34°F to +38°F. Draft towers cooled by continuous cold air circulation. Adjustable temperature control.
- **Approvals:** ETL Sanitation listed, UL, C-UL Safety listed, approved to NSF standard for packaged food products \*\*

### STANDARD FEATURES

- Adjustable temperature control
- Black front, sides and back
- Free flowing refrigeration system at all times to ensure uniformly cooled product
- LED interior light (except NLDD24)
- 5" casters standard on NLDD24 model only
- 3" diameter polished stainless steel draft tower
- 1 two-way gas manifold (NLDD59 & NLDD69), 1 three-way gas manifold (NLDD79), 1 four-way gas manifold (NLDD95)
- Slide out condensing unit
- Temperature range: +34°F to +38°F
- ETL Sanitation listed, UL, C-UL Safety listed, approved to NSF standard for packaged food products \*\*
- Warranties: 3 year parts & labor, 5 year compressor

### OPTIONAL FEATURES \*

- 4" plate-mounted casters
- Floor rack
- Single, double and triple tap draft tower

\*Most options are available one week from receipt of order. Please contact us for specific questions.

\*\* C-UL is Underwriters Laboratories Safety Certification Mark which indicates that UL has tested the equipment to applicable CSA Standards.

\*\* ETL Sanitation is Underwriters Laboratories Sanitation Mark which indicates that ETL has tested the equipment to applicable NSF Standards.

DIRECT DRAW BEER COOLERS

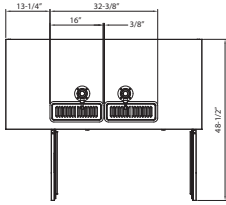

**TOP  
NLDD59**

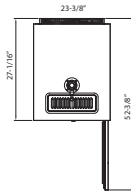

**TOP  
NLDD24**

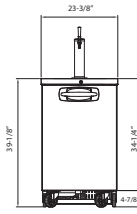

**FRONT  
NLDD24**

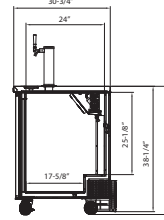

**SIDE  
NLDD24**

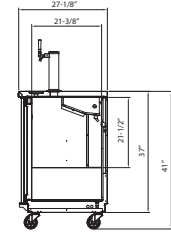

**SIDE  
NLDD59, 69, 79, 95**

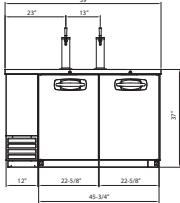

**FRONT  
NLDD59**

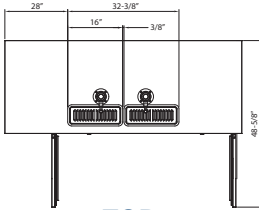

**TOP  
NLDD69**

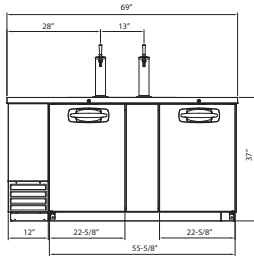

**FRONT  
NLDD69**

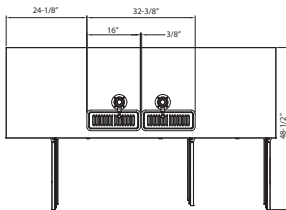

**TOP  
NLDD79**

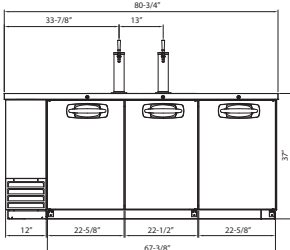

**FRONT  
NLDD79**

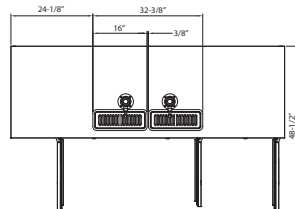

**TOP  
NLDD95**

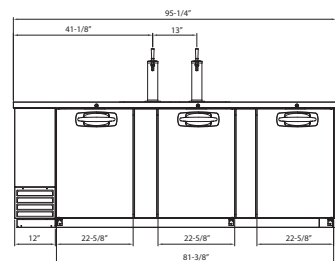

**FRONT  
NLDD95**



Revision Date: 4/18  
Part Number: 143585



©2018 Nor-Lake, Inc. A division of Standex International Corp. All rights reserved.  
Printed in the USA.

**SPECIFICATIONS**

<i>Models</i>	<i>NLDD24</i>	<i>NLDD59</i>	<i>NLDD69</i>	<i>NLDD79</i>	<i>NLDD95</i>
<i>Crated Weight (lbs) (kg)</i>	187 (85)	276 (125)	298 (135)	400 (182)	460 (209)
<i>Crated Height (in) (cm)</i>	44 (112)	44 (112)	44 (112)	44 (112)	44 (112)
<i>Crated Width (in) (cm)</i>	27-1/2 (70)	61-1/2 (156)	71-1/4 (181)	82-5/8 (210)	97-5/8 (248)
<i>Crated Depth (in) (cm)</i>	30 (76)	30 (76)	30 (76)	30 (76)	30 (76)
<i>Interior Height (in) (cm)</i>	31-3/4 (81)	31-3/4 (81)	31-3/4 (81)	31-3/4 (81)	31-3/4 (81)
<i>Interior Width (in) (cm)</i>	19-3/8 (49)	54-3/4 (139)	64-3/4 (165)	76-1/2 (194)	91 (231)
<i>Interior Depth (in) (cm)</i>	24 (61)	21-3/8 (54)	21-3/8 (54)	21-3/8 (54)	21-3/8 (54)
<i>Overall Height (in) (cm)</i>	39-1/4 (100)	37 (94)	37 (94)	37 (94)	37 (94)
<i>Overall Width (in) (cm)</i>	23-3/8 (59)	59 (150)	69-1/8 (176)	80-3/4 (205)	95-1/4 (242)
<i>Overall Depth (in) (cm)</i>	30-3/4 (78)	29-5/8 (75)	29-5/8 (75)	29-5/8 (75)	29-5/8 (75)
<i>Gross Cubage (CuFt) (L)</i>	7.9 (223.7)	19.4 (549.3)	23.4 (662.6)	27.9 (790)	33.6 (951.4)
<i>Number of Towers</i>	1 single	2 single	2 single	1 single 1 double	2 double
<i>Number of Kegs</i>	1	2**	3	4	5
<i>Condensing Unit Size</i>	1/5 HP	1/5 HP	1/3 HP	1/3 HP	3/8 HP
<i>Refrigerant</i>	R-134a	R-134a	R-134a	R-134a	R-134a
<i>Electrical Characteristics</i>	115/60/1	115/60/1	115/60/1	115/60/1	115/60/1
<i>Cord and Plug Furnished</i>	Yes	Yes	Yes	Yes	Yes
<i>NEMA Plug Configuration</i>	5-15P	5-15P	5-15P	5-15P	5-15P
<i>Total Amp Draw</i>	3.3	3.3	5.0	6.0	6.3

Specifications subject to change without notice.

\*\* The NLDD59 will hold (2) 1/2 barrel kegs and (1) slim quarter barrel.