

SS-276ULT BUILT-IN RECTANGULAR WARMER

SS-276ULT BUILT-IN RECTANGULAR WARMER



Wells SS-276ULT Built-In Rectangular Food Warmer is designed for top mount installation. This dependable and practical unit is made with a heavy-duty 12" x 27" stainless steel warming pan and is thermostatically controlled.

Features

- **1/3 larger capacity** than standard 12" x 20" units.
- **Warming pan is deep-drawn, stainless steel** construction for maximum strength and durability.
- **The tubular element**, located under the warming pan, allows for quick heating.
- **The positive-off thermostat** controls the element allowing for adjustable and more consistent temperatures. A signal light indicates that the heating element is energized.
- **Control** is recessed in a one-piece, drawn, stainless steel panel to help prevent accidental temperature changes.
- Available with **optional drain (D)**.
- **Wellslok** provides quick and easy installation in stainless steel countertops.
- Warmer is designed for **wet or dry operation**.
- **The SS-276ULT/TD Warmers** are Underwriters Laboratories, Inc. LISTED and meet NSF International and Canadian standards.
- **A one-year warranty** against defects covers parts and labor.

Specifications

Overall Dimensions:	Inches	MM
Width	13 1/2	343
Depth	28 1/2	724
Temperature Settings:	OFF/LO to HI	
Weights:	Lbs.	KG
Installed	19	9
Shipping	21	10

Accessories / Options

Adapter Top, to convert SS-276ULT to hold three 7-quart insets, 22589

Inset, 7-quart capacity with lid, 20587

Wellslok Extension Kit, designed for countertops up to 1 1/2" thick, refer to installation instructions, 22593

Drain Valve Extension Kit, extension from drain to counter front with remote handle, for use with "D" models only, 20385

Individual drain (D models) available





MODEL SS-276ULT BUILT-IN RECTANGULAR WARMER

DIMENSIONS:

INCH
(MM)

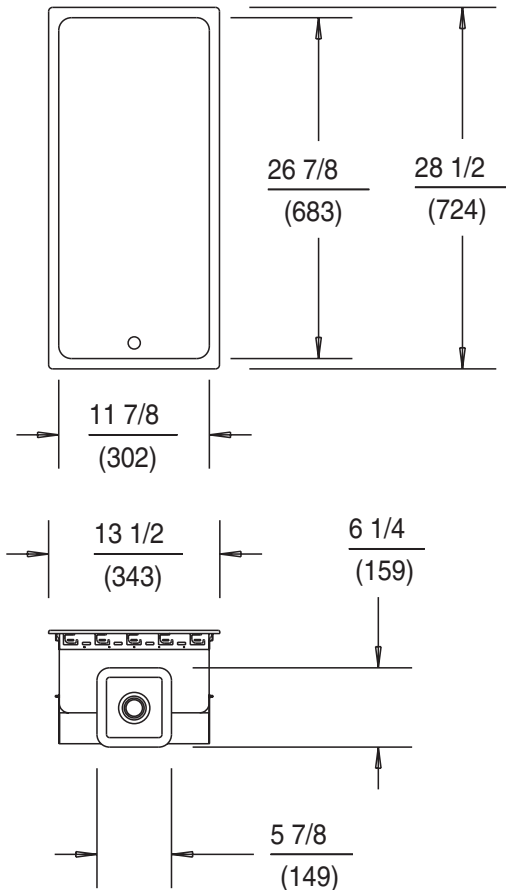

MINIMUM CLEARANCE UNIT TO THE NEAREST SURFACE			
BACK 2 (51)	SIDE 2 (51)	BOTTOM 6 3/4 (171)	FRONT* 4 1/8 (105)

* 2" if control box is located below the unit.

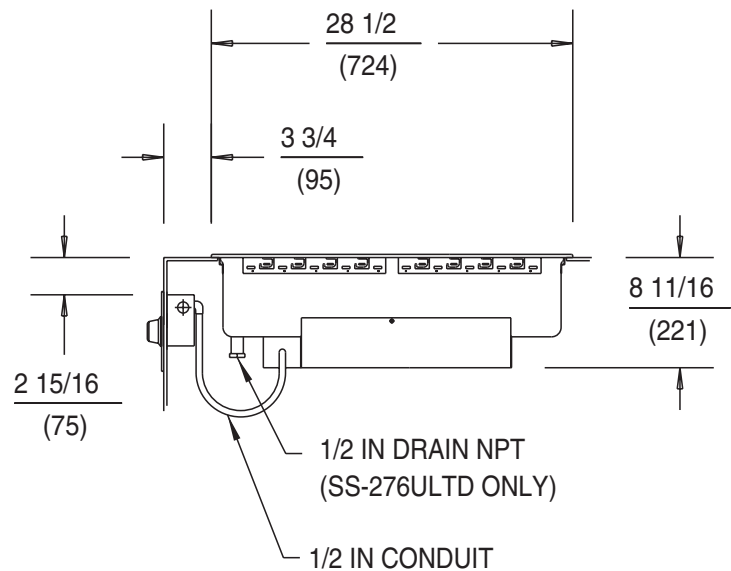

SS-276ULT ELECTRICAL SPECIFICATIONS:

MODELS	VOLTS	WATTS	AMPS	PHASE	POWER SUPPLY CORD
SS-276ULT	120	1650	13.8	SINGLE	NONE
SS-276ULT	208	1240	6.0	SINGLE	NONE
SS-276ULT	240	1650	6.9	SINGLE	NONE

All models with a 'D' suffix have the same electrical specifications as the standard models.

NOTE: Specifications are subject to change without notice. See installation instructions prior to installing the unit. This document is not for installation purposes.

