

Project Name: \_\_\_\_\_ AIA#: \_\_\_\_\_

Model #: \_\_\_\_\_ Location: \_\_\_\_\_

SIS#: \_\_\_\_\_ Item #: \_\_\_\_\_ Quantity: \_\_\_\_\_



# Premium Heavy-Duty Frozen Slicers

## Frozen Meat Slicer

*Great for Mongolian BBQ, Carna Asada, Shabu Shabu or Hot Pot!*



S13-F

### Models

- S13-F (Manual)
- S13A-F (Automatic)

### Standard Features

- Patent pending anodized aluminum design & construction for quick and easy cleaning
- Patent pending indexing system enables accurate and precise slice thickness adjustment up to 1-1/8"
- 13" serrated German steel knife with hardened edge provides quality slices and higher yield
- Tilting carriage accommodates up to 13.75" h, 8" dia., 11" w large products, like prosciutto, mortadella and bacon
- 50°, 13" tall gravity feed carriage improves productivity
- Advanced meat grip design for superior product hold
- 1/2 HP continuous use knife motor combined with the high efficiency knife drive system delivers optimum power
- No voltage release prevents inadvertent reactivation of slicer in the event of interlock or power interruption
- Interlock prevents slicer from operating without the knife cover in place
- Kickstand to facilitate ease of cleaning

### Standard Automatic Features

- Patent pending graphic user interface with Clear Text LCD display provides operator messages, diagnostics and system information
- Return to Home feature returns carriage to home position when powering off motor
- Single speed for optimal frozen slicing
- Carriage tilt interlock – prevents knife exposure when carriage is tilted
- Variable speed brushless auto mode motor delivers 3ft. lbs. of peak torque
- Patent pending auto engagement system ensures no slippage
- Lift lever to facilitate ease of cleaning

### Warranty

- Two year parts and labor

### Optional Accessories

- Food Fence
- Vegetable Hopper
- Slicer Cover
- Slaw Tray

*To select factory installed options and accessories see back*



REVIT



AutoQuotes

Approved by: \_\_\_\_\_ Date: \_\_\_\_\_

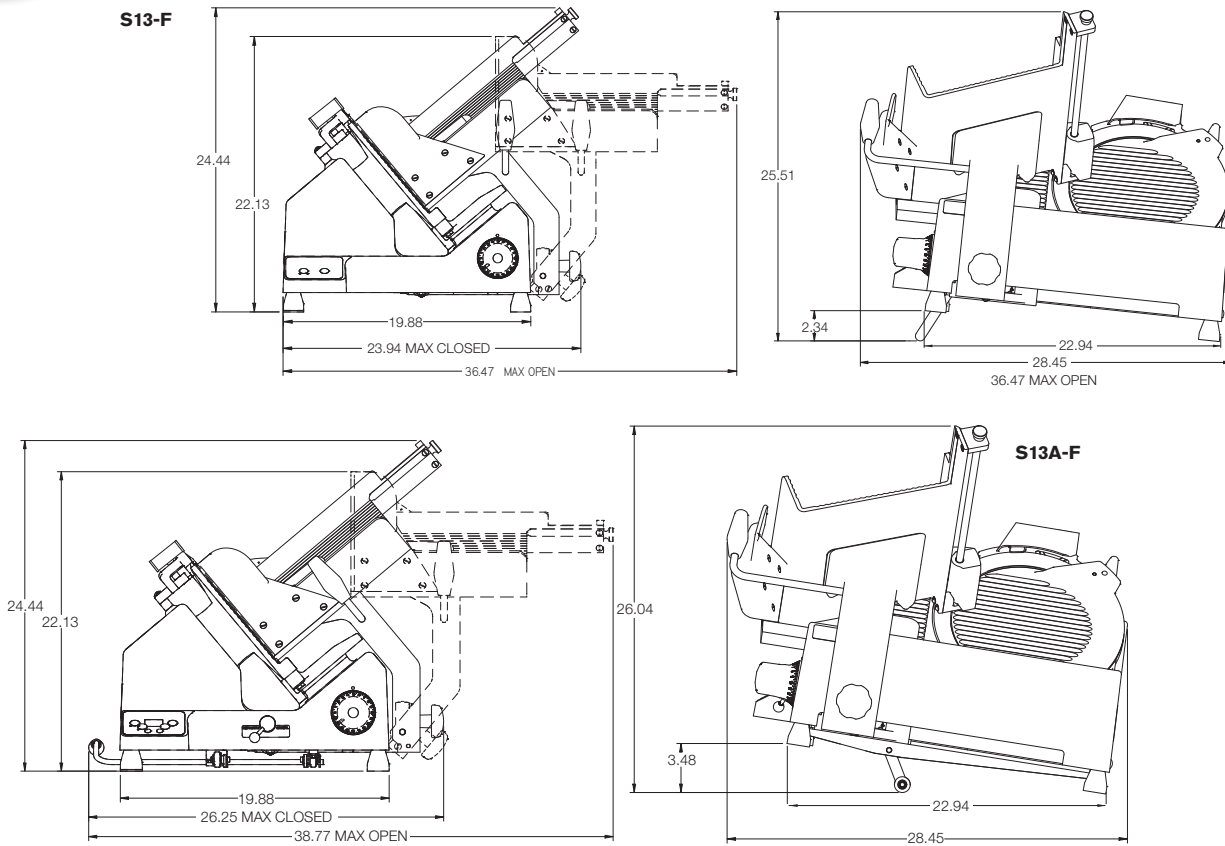

UNIT: Inches  
Drawings available through KCL. [www.kclcad.com](http://www.kclcad.com)

**SPECIFICATIONS**

| Model  | Motor  | Volts    | Amps | NEMA Plug Type | Drive Type | Slicing Vol. / Day | Cheese Slicing | Blade Diameter | Max Slice         | Product Cutting Capacity |                |                |
|--------|--------|----------|------|----------------|------------|--------------------|----------------|----------------|-------------------|--------------------------|----------------|----------------|
|        |        |          |      |                |            |                    |                |                |                   | D (Diameter)             | H (Height)     | W (Width)      |
| S13-F  | 1/2 HP | 115-60-1 | 2    | 5-15           | Belt       | All Day            |                | 13" (33.02 cm) | 1-1/8" (2.857 cm) | 8" (20.32 cm)            | 13.75" (35 cm) | 11" (27.94 cm) |
| S13A-F | 1/2 HP | 115-60-1 | 2.5  | 5-15           | Belt       | All Day            |                | 13" (33.02 cm) | 1-1/8" (2.857 cm) | 8" (20.32 cm)            | 13.75" (35 cm) | 11" (27.94 cm) |

**Cord & Plug:** Attached 7 ft. flexible 3-wire cord with molded plug fits a grounded receptacle. **Please specify desired plug configuration when ordering.**

**DIMENSIONS | SHIPPING INFORMATION**

Reinforced carton for shipping. The weight and dimensions of this reinforced carton are included below and may vary from shipment to shipment.

**Shipped on a pallet. Freight class 77.5.**

| Model  | Max Overall Dimensions  | Net Weight             | Shipping Dimensions                                    | Shipping Weight        |
|--------|---|------------------------|--|------------------------|
| S13-F  | 36.47" W x 29.56" D x 25.51" H<br>(92.63 cm x 75.08 cm x 64.8 cm) | 114 lbs.<br>(51.71 kg) | 31.5" W x 31.5" D x 31.5" H<br>(80 cm x 80 cm x 80 cm) | 135 lbs.<br>(61.24 kg) |
| S13A-F | 38.7" W x 26.7" D x 20.9" H<br>(98.5 cm x 68 cm x 53.1 cm)        | 127 lbs.<br>(57.61 kg) | 31.5" W x 31.5" D x 31.5" H<br>(80 cm x 80 cm x 80 cm) | 148 lbs.<br>(67.13 kg) |

**OPTIONAL ACCESSORIES:**

- Food fence
- SC Large - Slicer Cover
- Vegetable Hopper
- Slaw Tray

**S13-F:** Slicer to be constructed of anodized aluminum with built-in control panel. Slicer to have 1/2 HP motor with overload protection and 13" serrated German steel knife. Slicer to come with patent-pending indexing system with slice thickness adjustment up to 1-1/8". Tilting carriage accommodates up to 13.75" h, 8" dia, 11" w large products. Slicer is ETL listed. Slicer to have no voltage release and knife cover interlock. Two year parts and labor warranty. **S13A-F:** All previously stated, as well as Clear-Text display/control panel and single speed/stroke specifically designed for frozen product.