



Project: _____

Location: _____

Item #: _____ Quantity: _____

Model #: _____

MODEL: IAG-EML12CM1 **AIR CURTAINS – Vertical & Glass Sided**

General Strengths



- ✓ **Sanitation.** Ability of dismantling the shelves and guides for a correct cleaning of the machine's interior.
- ✓ **Control systems.** Higher precision in managing temperature settings. Greater ability to adjust of temperature ranges as per the end user's requirement.
- ✓ **100% Tested.** All condenser units are tested 100%, in helium chambers to refrigerant leak detections.
- ✓ **Modular Line.**
- ✓ **Certified.** Audited and Certified by **INTERTEK** for compliance with UL 471 and NSF 7. AENOR audited and certified by internationally recognized firm. ISO 9001:2008 (Quality); ISO 14001:2004 (Environmental); OSHAS 18001:2007 (Prevention and Worker Safety)
- ✓ **Lighting.** LED lighting in the canopy and under each shelf, reduces the energy consumption by 80% and 90% compared to a traditional bulb. Provides a much better light quality.

MODEL	Dimensions (inches) (mm)			Nº Shelves	Ref.	Ref. Weight (Lbs.) (gr.)	Temp. Range (°F) (°C)	Capacity (Cu. Ft.) (L)	Cond. Unit. H.P.	Case Amps		Crated Weight (Lbs.) (Kg.)
	W	D	H							115V	220V	
IAG-EML12CM1	52-1/4 1330	33-1/2 850	78-3/4 2000	4	R404A	1.43 650	33°F/41°F 0°C/5°C	31.53 900	1	3.4	5.8	636 290

ETL LISTED TO UL471 STANDARD AND SANITATION CLASSIFIED TO NSF7 – WE RESERVE THE RIGHT TO CHANGE SPECIFICATIONS WITHOUT PRIOR NOTICE



Infrico USA Corp.
7042 N.W. 46th Street
Miami, FL 33166
1.305.777.9599 Office
1.305.777.9598 Fax

www.infrico.us
service@infrico.com
sales@infrico.com

APPROVALS: AVAILABLE AT



Project: _____

Location: _____

Item #: _____ Quantity: _____

Model #: _____

MODEL: IAG-EML12CM1

AIR CURTAINS – Vertical & Glass Sided

STANDARD FEATURES

➤ **Exterior**

- Pull down night curtain,
- Black (RAL 9017) prepainted steel cabinet, standard,
- Glass sided panels,
- Heavy duty ball transfer and levelling feet.

➤ **Interior**

- **LED lighting** in canopy and under each shelf.
- Black (RAL 9017) prepainted steel cabinet, standard,

➤ **Shelving**

- (4) Four rows of adjustable shelves,
- Price channels included.

➤ **Insulation**

- CFC-Free polyurethane insulation, entire cabinet structure is foamed-in place using a high density polyurethane insulation,
- Low GWP & Zero ODP effect.

➤ **Refrigeration**

- Digital temperature controller with automatic defrost system,
- **Double Stainless Steel evaporative pan system, first, by hot gas, second, by electrical resistance,**
- Extractable condensing unit for easy service,
- Forced air refrigeration system,
- Case engineered to operate at 75°F (25°C). and 55% relative humidity,
- Refrigeration capacity: 6436 Btu/h(5°F) / 1886 W(-15°C).

OPTIONAL FEATURES

- ✓ Customizable decoration for lower front and side panels,
- ✓ Optional decoration: Dark blue RAL 5017, Orange RAL 2003, Dark green RAL 6018, Yellow RAL 1018, Maroon RAL 3003, White RAL 9016,
- ✓ Electrical connection is 230V / 1ph / 50 Hz (plug type varies).

➤ **Electrical**

- Cord and NEMA L14-30P plug. Electrical connections are 230V / 1ph / 60 Hz (compressor) and 115V / 1ph / 60 Hz (digital control).



➤ **ETL Listed to UL471 Standard and Sanitation classified to NSF7.**

PLAN VIEW

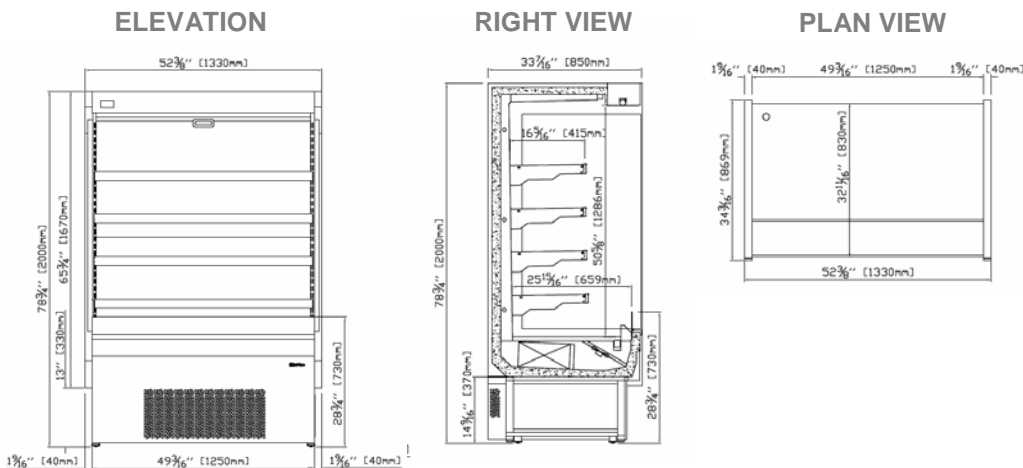

ETL LISTED TO UL471 STANDARD AND SANITATION CLASSIFIED TO NSF7 – WE RESERVE THE RIGHT TO CHANGE SPECIFICATIONS WITHOUT PRIOR NOTICE



Infrico USA Corp.
 7042 N.W. 46th Street
 Miami, FL 33166
 1.305.777.9599 Office
 1.305.777.9598 Fax

www.infrico.us
 service@infrico.com
 sales@infrico.com

APPROVALS: AVAILABLE AT