

MODEL: IUC-MSG48 **CHEF BASES:**
Drawered Refrigerator



AISI 304 Stainless Steel worktop with drip guard marine edge, standard.



Heavy-duty stainless steel drawer slides designed to hold up to 440 Lbs. (Pans Not Included)

General Strengths

- ✓ **Worktop.** Cabinet top is one piece, heavy duty reinforced stainless steel. Drip resistant "V" edge protect against spills.
- ✓ **Drawers.** All drawers include triple chamber door gaskets, easy to remove and snap in. Heavy-duty stainless steel slides hold up to **440 lbs.** Integrated handle and self-closing device.
- ✓ **Control systems** Higher precision in managing temperature settings. The ability to adjust temperature ranges to meet end user's requirements.
- ✓ **100% Tested.** All condensing units are 100% tested in helium chambers in order to detect refrigeration leaks.
- ✓ **Certified.** Audited and Certified by **INTERTEK** for compliance with UL 471 and NSF 7. AENOR audited and certified by internationally recognized firm. ISO 9001:2008 (Quality); ISO 14001:2004 (Environmental); OSHAS 18001:2007 (Prevention and Worker Safety)

MODEL	Dimensions (inches) (mm)			Nº Drawers	Nº Pans	Ref.	Ref. Weight (Lbs.) (gr.)	Temp. Range (°F) (°C)	Capacity (Cu. Ft.) (L)	Cond. Unit. H.P.	Case Amps 115 V.	Crated Weight (Lbs.) (Kg.)
	W	D	H									
IUC-MSG48	48-5/8 1235	32-1/2 825	26-1/4 666	2	4	R134a	0.42 190	33°F/38°F 0°C/4°C	6,8 193	1/5	4,8	280 127

ETL LISTED TO UL471 STANDARD AND SANITATION CLASSIFIED TO NSF7 – WE RESERVE THE RIGHT TO CHANGE SPECIFICATIONS WITHOUT PRIOR NOTICE

MODEL: IUC-MSG48
**CHEF BASES:
Drawered Refrigerator**
STANDARD FEATURES
➤ Exterior

- AISI 304 Stainless Steel Top. Drip resistant "V" edge protects against spills,
- Front and sides in AISI 430 Stainless Steel.

➤ Interior

- AISI 430 Stainless Steel,
- Sealed interior floors.

➤ Casters

- 4" diameter casters,
- Locks provided on front set.

➤ Drawers

- Each drawer accommodates two full 12"x20" pans (pans not included),
- Drawers with full-extension sliding rails for complete opening,
- Drawers with integrated handle,
- **Heavy-duty stainless steel drawer slides designed to hold up to 440 Lbs (200 Kg).**

➤ Insulation

- CFC-Free polyurethane insulation, entire cabinet structure is foamed-in place using a high density polyurethane insulation,
- Low GWP & Zero ODP Effect.

➤ Refrigeration

- Digital temperature controller with automatic defrost system,
- Stainless steel evaporative pan,
- **Compact refrigeration system monoblock, INFRIBLOCK®,**
- **Extractable condensing unit for easy service,**
- Evaporator coil coated with anti-corrosion material 100% Polyester,
- Front-breathing refrigeration system,
- Forced air refrigeration system,
- Refrigeration capacity: 1314 Btu/h (14°F) / 385 W (-10°C).

➤ Electrical

- Cord and NEMA 5-15P plug,
- Electrical connection is 115V / 1ph / 60 Hz.

OPTIONAL FEATURES

- ✓ Set of 6" legs, height adjustable from 5" to 8",
- ✓ Electrical connection is 220-230 V / 1ph / 50 Hz (plug type varies).

- **ETL Listed to UL471 Standard and Sanitation classified to NSF7.**

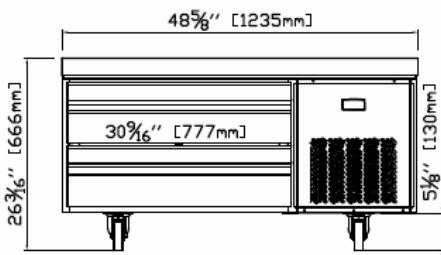
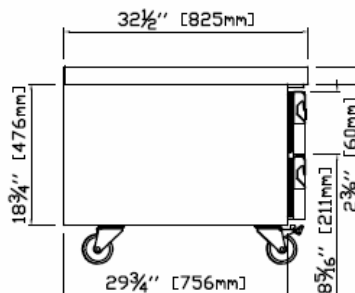
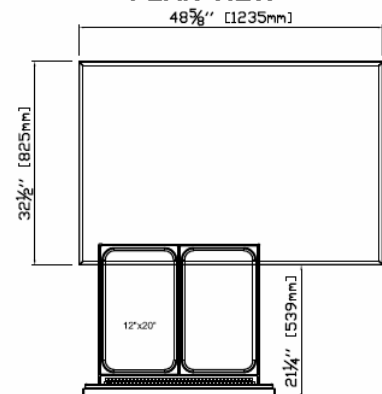
PLAN VIEW
ELEVATION

RIGHT VIEW

PLAN VIEW

ETL LISTED TO UL471 STANDARD AND SANITATION CLASSIFIED TO NSF7 – WE RESERVE THE RIGHT TO CHANGE SPECIFICATIONS WITHOUT PRIOR NOTICE