

PROJECT NAME: _____ LOCATION: _____

ITEM: _____ MODEL: _____

Pizza Prep Tables



FEATURES LIST

CPR-44-X, CPR-49-X, CPR-67-X, CPR-70-X, CPR-93-X

- Stainless steel exterior, aluminum interior and back.
- Refrigeration system keeps food at safe temperatures between 33°F and 41°F
- Self-Closing doors with 90 degree stay-open feature.
- Shelves: Adjustable heavy-duty PVC coated shelves.
- Comes standard with NSF approved food pans and cutting board.
- Electronic control system makes it easy to adjust temperature set point and defrost frequency.
- Pre-installed 4" swivel casters with brakes.
- Easy to access condenser coil for cleaning and service.
- Uses R290 refrigerant, which is eco-friendly and more efficient.
- **WARRANTY:** 2 Years Parts and Labor and an additional 3 Years on Compressor.

* Not suitable for installation in a non-commercial or residential application

Approvals



As continued product improvement is a policy, specifications are subject to change without notice

CONFORMS TO NSF/ANSI STD 7

PLAN VIEW

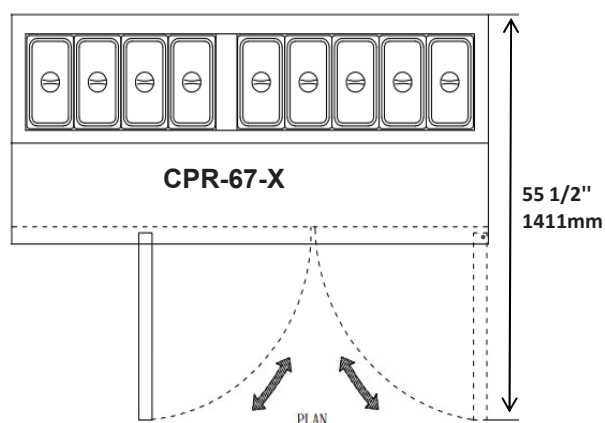
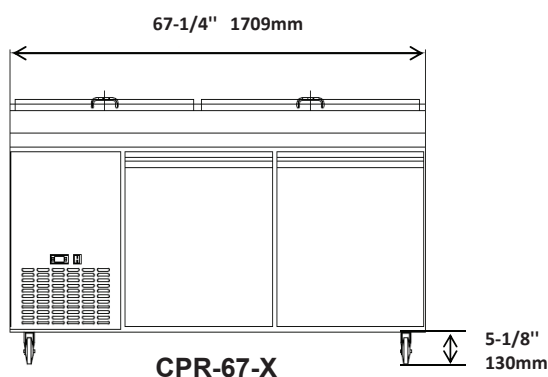
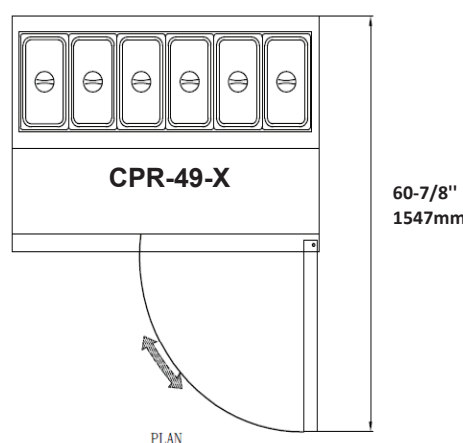
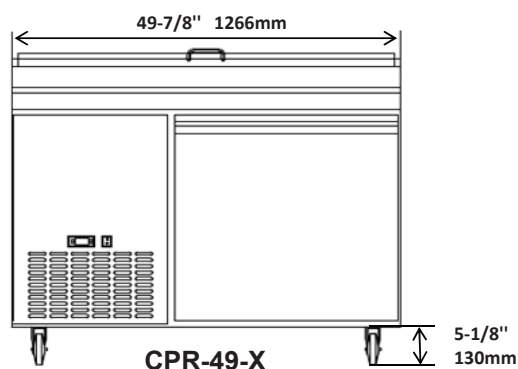
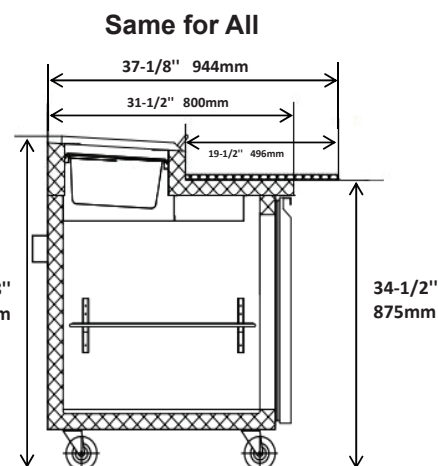
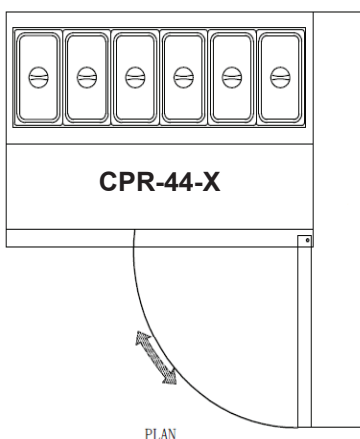
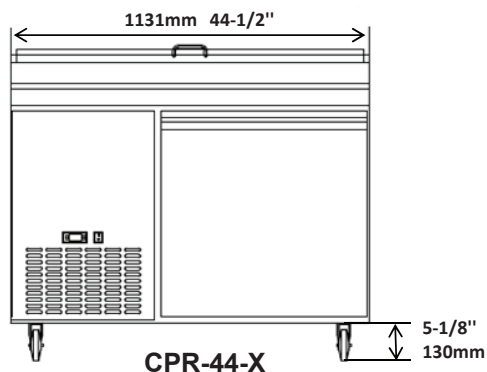

Model	Doors	Shelves	Cabinet Dim (in)			HP	Voltage /Hz /ph	Amp	NEMA Plug	Cord Lgth (ft)	Ship Weight (lbs)
			L	D	H						
CPR-44-X	1	1	44.5	31.5	38.375	1/6	115/60/1	4.5	5-15P	10	325
CPR-49-X	1	1	49.875	31.5	38.375	1/6	115/60/1	4.5	5-15P	10	354
CPR-67-X	2	2	67.25	31.5	38.375	1/5	115/60/1	6.0	5-15P	10	435

PLAN VIEW

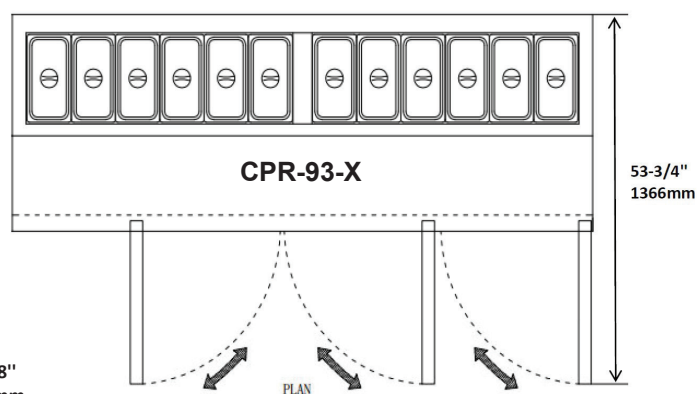
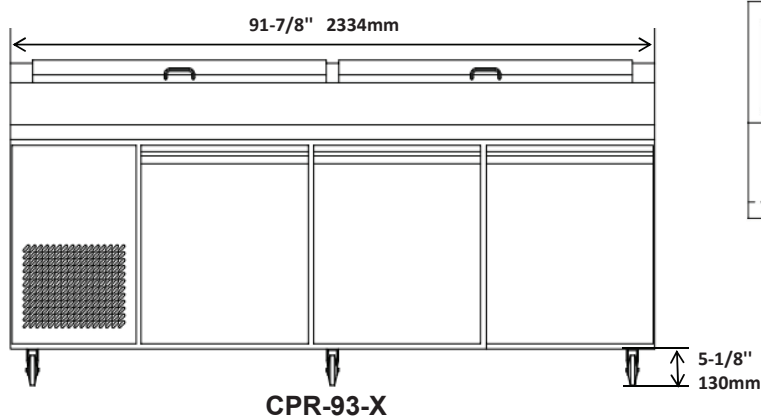
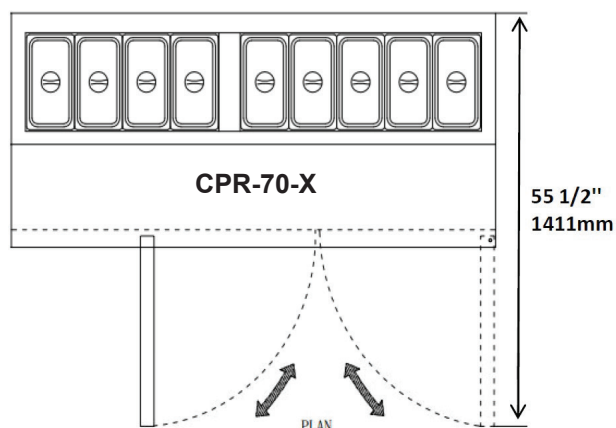
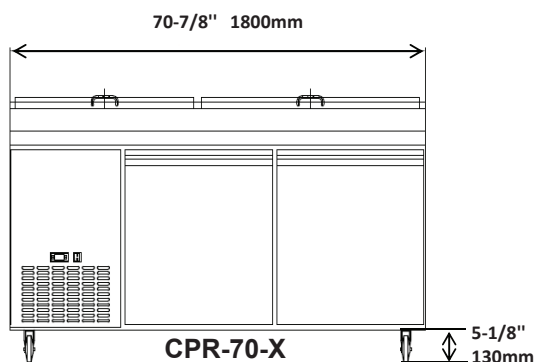

Same for All

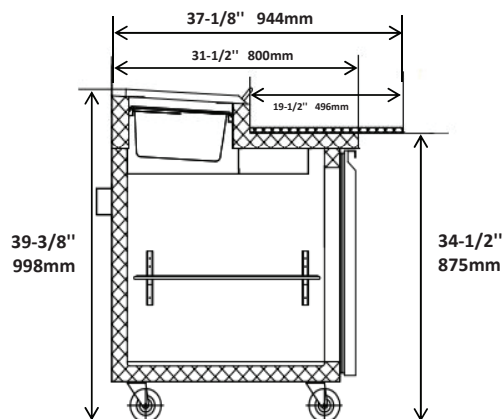

Model	Doors	Shelves	Cabinet Dim (in)			HP	Voltage /Hz /ph	Amp	NEMA Plug	Cord Lgth (ft)	Ship Weight (lbs)
			L	D	H						
CPR-70-X	2	2	70.875	31.5	38.375	1/5	115/60/1	5.5	5-15P	10	453
CPR-93-X	3	3	91.875	31.5	38.375	1/4	115/60/1	7.2	5-15P	10	719

Pizza Unit Cutting Boards and Dimensions

Model	Cutting Board Dim (in)		
	L	D	Thickness
CPR-44-X	44.5	19.5	0.6
CPR-49-X	49.5	19.5	0.6
CPR-67-X	67.3	19.5	0.6
CPR-70-X	70.8	19.5	0.6
CPR-93-X	91.8	19.5	0.6

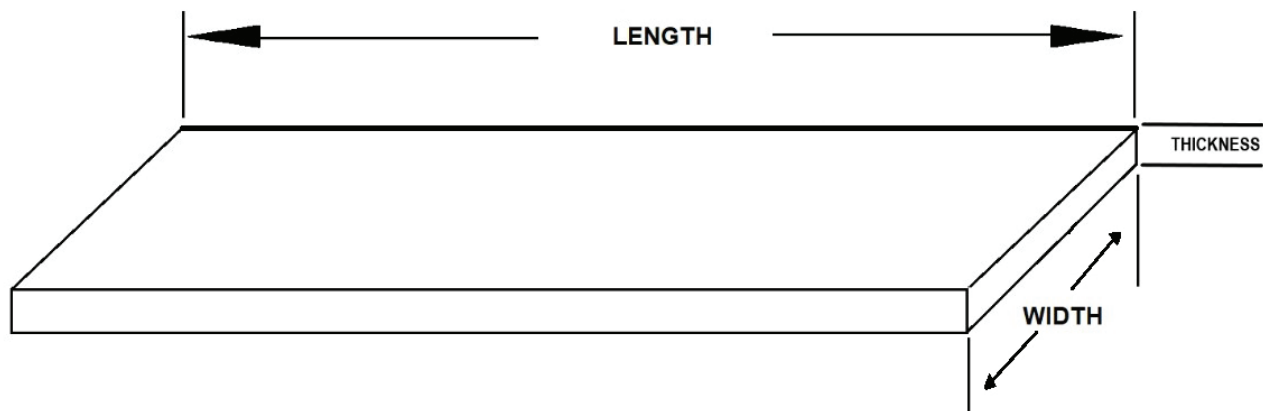

Approvals

