



VALPRO COMMERCIAL REFRIGERATION

5256 Eagle Trail Drive

Tampa, FL 33634

813-502-0300

Toll Free 1-888-VALPRO-8

www.ValproRefrigeration.com

sales@ValproRefrigeration.com

PROJECT:	
MODEL #:	
ITEM #:	QTY:
AVAILABLE W/H:	
APPROVAL:	

DIRECT DRAW BEER DISPENSER 49" MODEL: VPBD2-2

We are proud to introduce the beautifully constructed **Valpro VPBD2-2 direct draw beer cooler**. All our bar refrigeration equipment are manufactured with uncompromising quality, energy efficient technology, and standard premium features built in. All our direct draw beer coolers are designed to accommodate a variety of beer kegs, and have full stainless steel interiors, solid foamed stainless steel tops with integrated drip tray drain. Our heavy duty commercial construction will provide many years of worry free service and delivers cost saving eco-friendly energy efficiency with more affordable running costs. This unit utilizes natural hydrocarbon R290 refrigerant as an environmentally responsible choice having low global warming potential and no potential for ozone depletion. All Valpro products are manufactured under strict ISO9001 standards for quality assurance, and to consistently deliver to our customers products that satisfy all expectations. All our products are operated, extensively monitored, and undergo rigorous inspection prior to packaging and shipping.



Intertek



Intertek



Certified to ANSI/NSF 7 Standards

FEATURES

- Solid foamed stainless steel counter top with integrated drip tray drain
- Full stainless steel interior
- LED cabinet lighting
- Attractive black powder-matted galvanized steel exterior
- Self closing doors with key locks
- Snap-in magnetic door gaskets removable and replaceable without tools for ease of cleaning
- Two cooled (cold air channeled) and insulated 3" diameter beer columns for uniform beer temperature and reduced foaming for a perfect pour
- One faucet on each polished stainless steel tower
- Designed to hold a variety of kegs, will hold 2 half barrel kegs
- Standard 4" casters, make it easy to maneuver and clean underneath
- High density foamed in place CFC free insulation
- Over sized balanced refrigeration system uses environmentally friendly R290 hydrocarbon refrigerant with low GWP and zero ozone depletion
- Side mounted evaporator system
- Forced air cooling with large fan motor and fan blades for better air circulation
- Front mounted electronic thermostat digitally controlled temperature system maintains optimum temperature with easily viewed LED display
- Certified and tested to NSF Standard 7



Model:
VPBD2-2

49" Direct Draw Beer Dispenser

2 Towers - 1 Tap Each Tower

Technical Data

Dimensional Data

Exterior Dimensions	49.1"W x 24.4"D x 36.2"H
Keg Capacity	Variety, will hold 2 Half Barrels
Storage Capacity Cu. ft.	10.45
Crated Weight	267 lbs.
Shipping Dimensions	50.6"W x 26.7"D x 44.5"H

Refrigeration Data

Temperature Range	33°F - 41°F
Refrigerant	R290
Refrigerating System	Capillary Tube
Temperature Controller	Digital
Horsepower	2/5
Evaporator/Condenser	Aluminum + Copper
Condensing Unit	Side Mount

Construction Data

Exterior Material	Black Powder Coat Steel
Interior Floor Material	430 Stainless Steel
Interior Wall Material	430 Stainless Steel
Insulation	CFC Free Polyurethane
Doors	2 Hinged
Cooled Insulated Columns	2
Faucets	2 (One/Tower)

Electrical Data

Interior Lighting	Efficient LED
Amps	3
Voltage/Frequency/Phase	115V/60Hz/1
Plug Type	NEMA 5-15P
Electrical Cord Length	8.2 ft.

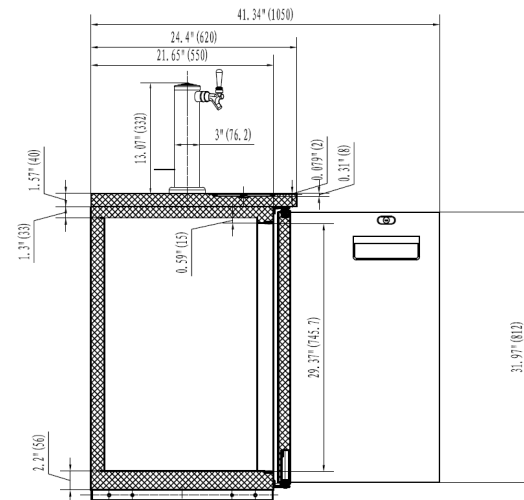
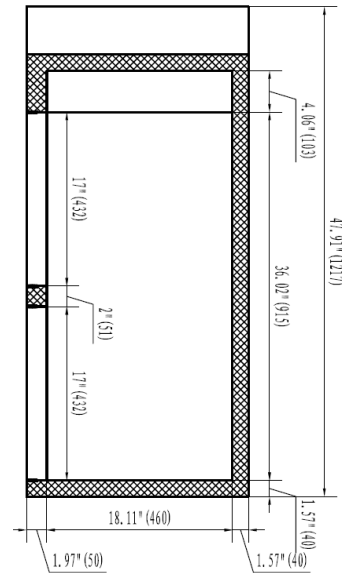
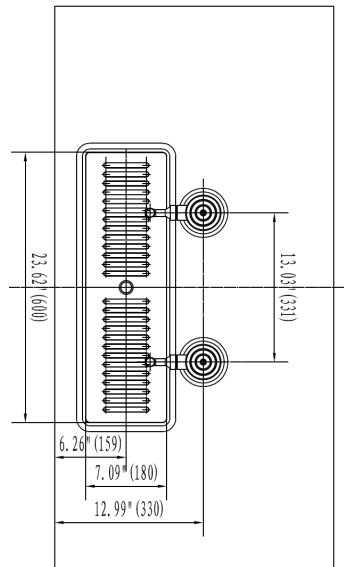
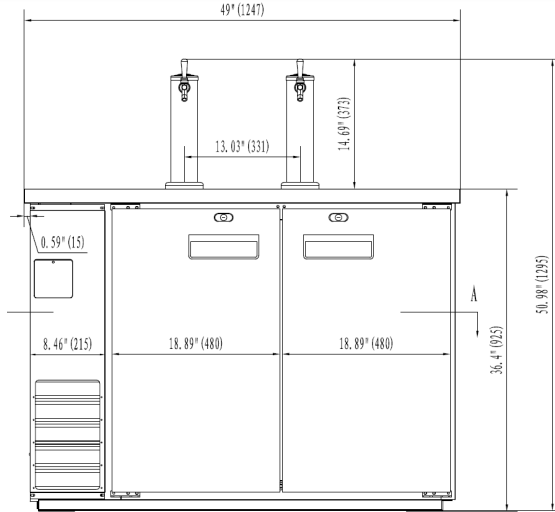

Intertek



Intertek

Due to periodic changes in designs, procedures and regulations the specifications in these sheets are subject to change without notice. Ver. 201707

Certified to ANSI/NSF 7 Standards

Valpro Commercial Refrigeration
5256 Eagle Trail Drive
Tampa, FL 33634



Tel: 813-502-0300
1-888-VALPRO-8
www.valprorefrigeration.com